



# INTRODUCING THE LINCOLN PEAK 18'

BY TINY MOUNTAIN HOUSES  
CERTIFIED RECREATIONAL VEHICLE – DOT APPROVED



## THIS BEAUTIFUL HAND CRAFTED HOME IS WELL APPOINTED WITH

- Barrel roof
- Metal roof, 40 year
- 30" entry overhang w/ chain accents
- Custom window package
- Dual glazed, vinyl, low-e. Argon gas filled, residential windows
- Board and Batt exterior with Cedar accents
- LP 40 year hardboard siding with LP rough sawn trim
- 30 amp main electrical service w/ 25' power cord, 110 volt
- Craftsman exterior door w/ custom paint
- Specialty exterior lights
- Metal window and door flashing throughout
- Whole house wrap
- One Exterior GFCI
- Insulation: R-15 walls and ceiling, R-13 in the floor
- 10 Gallon propane/ electric combination water heater
- Under the counter stainless finish refrigerator
- Two Burner electric glass cooktop - black
- Wall mounted electric heater
- Residential stainless steel kitchen sink w/ gooseneck pullout faucet
- 24" black range hood
- Laminate countertops w/ tile backsplash
- Custom butcher block black walnut shelving w/ chain accent
- Specialty finish kitchen cabinets
- Madura style cabinet hardware
- Full-depth drawer guides
- Butcher block black walnut floating table w/ chain supports
- Propane prep with tank shelf, housing and regulator
- White bead board interior walls
- Weathered grey finish ceilings
- Weathered grey trim package throughout
- Pocket door to bath
- 36" fiberglass one piece shower
- Petite sink w/ contemporary faucet
- Residential toilet
- Trimmed mirror over sink
- Rolled vinyl flooring
- Pine T & G flooring in loft
- Wire and brace for a ceiling fan
- Three way electrical switches to sleeping loft

8'6" WIDE x 18' LONG x 13'6" TALL  
APPROXIMATELY 210 SQ. FT.  
6,600 LB. DRY WEIGHT

VALUE SERIES PRICE  
**\$57,960\***

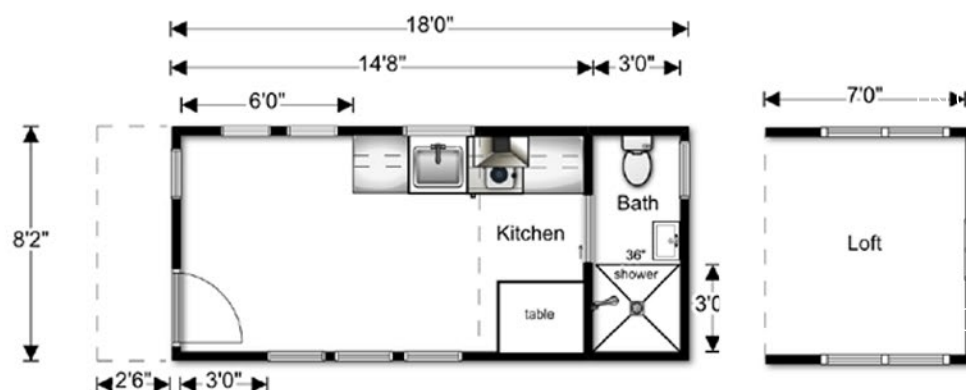

\*Plus freight and applicable taxes. Furnishing & décor items not included

800.605.8329 | INFO@TINYMH.COM | WWW.TINYMOUNTAINHOUSES.COM