



INTRODUCING THE MT.HOOD 24'

BY TINY MOUNTAIN HOUSES



THIS BEAUTIFUL HAND CRAFTED HOME IS WELL APPOINTED WITH

STANDARDS

- Metal standing seam roof
- White beadboard walls and ceiling
- Pine tongue and groove flooring – both lofts
- Fiberglass 48" shower
- Wire and brace for fan & light 3-way switch
- Brushed nickel wall sconces
- Track lighting in kitchen & bedroom
- Dual glazed, vinyl low-e, white residential windows
- Z-metal flashing on all windows
- Insulation, R-15 in walls and ceiling, R-13 in the floor
- LP 40 yr hardboard siding
- Brushed nickel door hardware
- 50 amp electrical service
- Kitchen drawers with full extension drawer guides
- Laminate countertops throughout
- Rolled vinyl flooring

OPTIONS

- Dishwasher, stainless steel
- Interior upgrade trim package
- Separett Composting Toilet
- Contemporary satin nickel cabinet pulls
- OSB underlayment interior walls
- Added bank of drawers – bath
- Stainless refrigerator w/ freezer
- 3 way electrical switches in sleeping lofts
- "Galvalume" metal accent
- Fully lofted roof/ ceilings
- Prep for stacked w/d – bedroom
- Apron sink
- 4 Transom windows & enlarged LRM windows
- 6' Glass door with built-in blinds
- Single light French entry door with built-in blinds
- On demand hot water heater
- Pocket door to bath and bedroom
- Mini split heat/ cool system
- 3 burner propane stainless range
- White beadboard cabinets

8'6" WIDE X 25' LONG X 13'6" TALL
APPROXIMATELY 333 SQ. FT.
9,100 LB. DRY WEIGHT

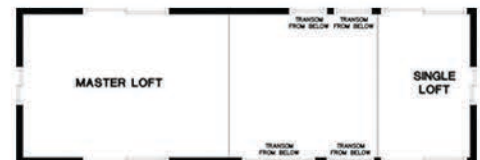

STANDARD BASE PRICE,

\$ 56,590

+ OPTIONS

\$ 21,550

TOTAL,

\$ 78,140

*Plus freight and applicable taxes. Custom furnishings, bed, couch, and custom King loft ladder not included.

800.605.8329 | INFO@TINYMH.COM | WWW.TINYMOUNTAINHOUSES.COM