

Introducing the TMH Cottage Rancher Series Neskowin 20'

By Tiny Mountain Houses

Certified Recreational Vehicle- DOT Compliant

This beautiful hand crafted home is well appointed with the following specifications:

- Detachable hitch
- Deck over floorplan, no wheel wells
- Single level design
- Residential low E Vinyl white windows with Argon gas
- Insulation, R19 Floors and ceiling, R-13 Walls
- Main Electric Panel (50 Amp) 220 V
- Exterior hose bib
- Full Exterior Cottage Lap Siding
- Cedar Shutters
- 30 yr Black Architectural Fiberglass Shingle Roof
- Half-light custom painted front door, 36"
- Custom porchlight
- Interior white shiplap
- 8'1" high ceilings
- Craftsman style window and door trim throughout
- 5" Baseboard with crown molding throughout
- Pocket door to bath 32"
- 48" Shower, One-piece
- Bathroom vanity with quartz countertop & backsplash & under-mount sink residential toilet
- Mirrored medicine cabinet & second mirror over sink
- Countertop Microwave Range Hood
- 30" Stainless Steel Electric Range
- Under counter 3.1 Cu. Ft. refrigerator w/freezer
- Quartz Countertops t/out including backsplash
- Rectangular stainless under-mount kitchen sink
- Spring style commercial kitchen faucet - Satin Nickel finish
- Shaker white cabinets
- Cabinet wardrobe storage
- Soft-close cabinet doors & drawers w/full extension drawer guides Pull out trash can drawer
- Matt black cabinet hardware, Entry door, Bath faucets, Towel and TP & cab door hardware
- 32" LED TV w/remote
- 20 Gallon electric water heater
- Mini-split heating/cooling system
- Rocker switches

- LED can lights
- USB outlet





Floor plan
 FLOOR PLAN
 170 SQ.FT.

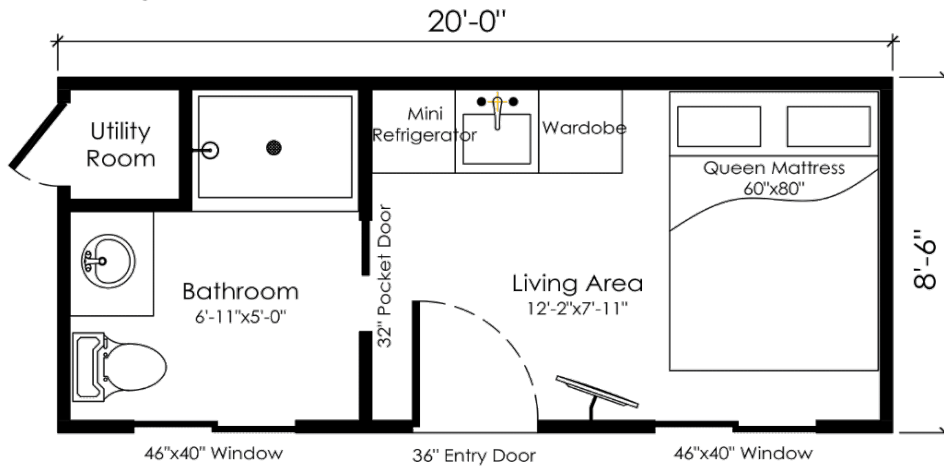

8'6" wide x 20' long x 13'0" tall
 Approximately 170 sq. ft.
 7,800 lb. dry weight

Price.... \$ 63,990
 Plus freight, title registration & applicable taxes



Tiny Mountain Houses *"Premier providers of Tiny Homes"*

Office: [\(800\) 605 8329](tel:8006058329) E: info@tinymh.com Web: tinymountainhouses.com/