



PRE OWNED CASTLE PEAK 26'

BY TINY MOUNTAIN HOUSES
RECREATIONAL VEHICLE – RIVA CERTIFIED – DOT APPROVED



THIS BEAUTIFUL HAND CRAFTED HOME IS WELL APPOINTED WITH

- Metal standing seam roof 40 Yr
- Whole house wrap
- White beadboard walls and ceiling
- Fiberglass 48" 1- piece shower
- Extended height overhead cabinets
- 3-way electrical switches to loft lighting
- Pine tongue and groove flooring – lofts
- Flex room with Pine 4 x 4 clear coat beams and T & G ceiling
- Wire and brace for ceiling fan
- Brushed nickel wall sconces
- Track lighting in kitchen
- Dual glazed, vinyl Low-E, white residential windows
- Metal flashing on all windows
- Insulation, R-15 in walls and ceiling, R-13 floor
- LP hardboard siding 40 yr
- Brushed nickel door hardware
- Exterior vented exhaust fans in kitchen & bath
- Drawers with full extension guides
- Residential flush toilet
- Shed roof accent w/cedar T&G interior ceiling in the shed area
- Extended height interior ceilings drop axles
- Single light entry door with built-in blinds & custom paint
- Upgrade satin nickel contemporary entry door lockset
- Added second porch light with w/upgrade fixtures
- On-demand propane tankless hot water heater
- Ductless mini split heating/ cooling system
- 50 Amp 220 V electrical system w/25' ship to shore power cord
- 3 cm Quartz kitchen counters
- Full tile kitchen backsplash with Schluter edging
- Apron-style white kitchen sink
- Commercial spring-style faucet
- Freestanding stainless range, propane w/cast iron grates
- Stainless steel vented rangehood
- LG 11.1 CF stainless top freezer refrigerator
- White shaker cabinets
- Walnut butcher block fold down murphy table
- Contemporary brushed nickel rod style hardware
- Soft close cabinet doors & drawers
- Prep for Washer/dryer in pantry cab
- Ribbon staircase with w/chunky step treads
- Beveled edge mirrored medicine cabinet in bathroom
- Bank of drawers bathroom
- Upgrade bathroom backsplash
- Ladder to the second loft with w/hardware
- Bronze ceiling cage fan
- LED lighting throughout

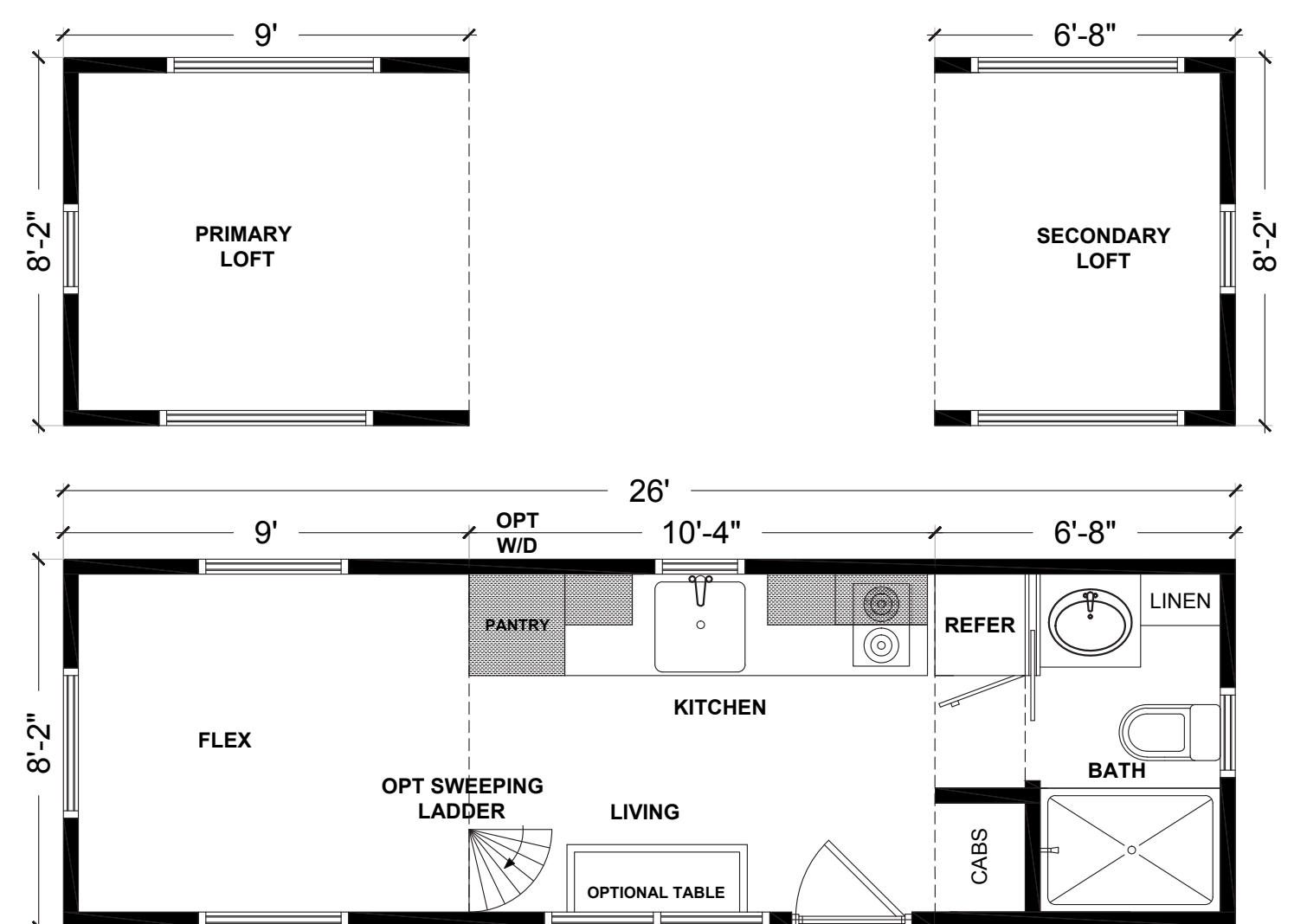

PRICE
\$115,650
(Plus freight, Doc fees & applicable taxes)

8'6" WIDE x 26' LONG
x 13'6" TALL
APPROXIMATELY
358 SQ. FT.
11,600 LB. DRY WEIGHT

*Furnishings & décor items not included

800.605.8329 | INFO@TINYMH.COM | WWW.TINYMOUNTAINHOUSES.COM