



The Chinook Peak

By Tiny Mountain Houses

Recreational Vehicle- DOT Compliant



This beautiful pre-owned hand crafted MODEL home is well appointed with

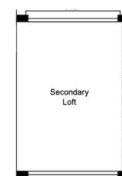
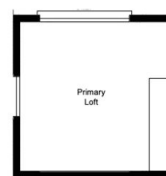
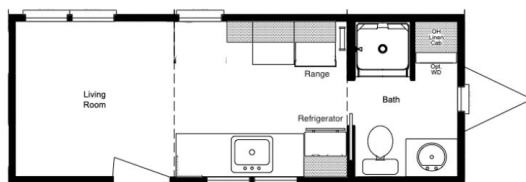

* Floor plan does not reflect 2' extension or 48" shower and extended vanity

The following

- Metal standing seam roof 40-year warranty
- Whole house wrap
- Dual glazed, vinyl Low-E, Argon gas white residential windows
- Insulation, R-15 in walls and ceiling, R-13 floor
- Window package with 80" Kitchen windows & added LRM windows
- LP hardboard siding, 40-year warranty
- White beadboard finish walls
- Fiberglass 1-piece 48" shower with enclosure
- Extended-height overhead cabinets
- 3-way electrical switches to loft lighting
- Pine tongue and groove flooring - Both lofts
- Living room with finished beadboard ceiling
- Ceiling fan installed
- LED wall sconce lighting
- Track lighting in the kitchen
- Brushed nickel interior door hardware
- Exterior vented exhaust fan bath
- Drawers with full extension guides
- Residential elongated toilet w/bidet attachment
- Single light entry door with built-in blinds & custom paint
- Upgrade contemporary entry door lockset
- Upgraded porch light fixture
- On-demand propane tankless water heater
- Ductless mini split heating/ cooling system 12,000 BTU
- 30 Amp 220 V electrical system w/25' ship-to-shore power cord
- Butcher block kitchen counters
- Full tile kitchen custom backsplash
- 9" deep undermount stainless steel kitchen sink
- Commercial spring-style faucet brushed nickel finish
- Drop in black range, propane w/cooktop
- Black rangehood vented to exterior
- Stainless steel refrigerator w/top freezer
- White shaker cabinets w/fingerpull
- Washer/dryer combo in bath
- Built-in storage staircase with handrail to primary loft
- Extended vanity cab w/added drawer bank
- Beveled edge 48" bath mirror above vanity
- Upgrade bathroom backsplash
- Built-in wall ladder to the second loft with powder coat finish
- LED lighting throughout
- Built-in custom dresser cabinet w/butcherblock top in primary loft
- Flat screen LED wall mount TV

8'6" wide x 24' long x 13'5" tall
 Approximately 338 sq. ft. 8,900 lb. dry weight

Total
\$89,295

*Price does not include doc fees & applicable taxes. Furnishings and decor not included