

# Columbia II

By Tiny Mountain Houses

Recreational Vehicle– DOT Compliant

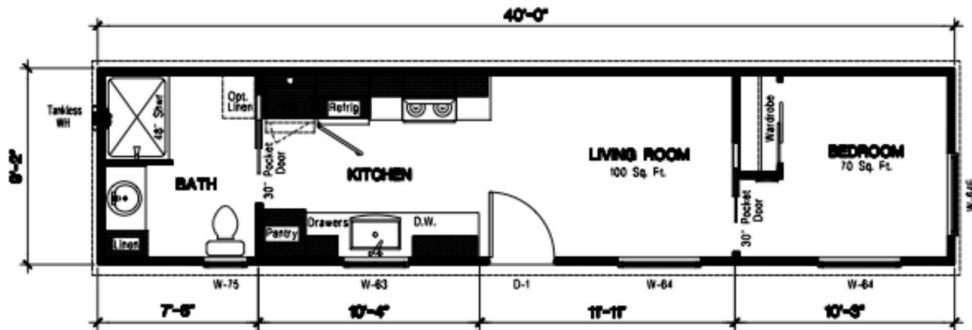

## STANDARDS

- Deck over floorplan ( No wheel wells)
- 4 integrated scissor jacks
- Windows residential Low E glazed, Argon gas 46" tall
- Insulation Floor R19, Ceiling R28, Walls R-11
- Residential 40-year hardboard siding
- Metal standing seam 40 Year roof
- Switched exterior holiday outlet
- Single slope shed style contemporary roof with eaves
- 36" Nine lite entry door with a deadbolt
- 5/4 Rough-sawn trim throughout
- Porchlight, Electrical outlet/Patio plug
- Vinyl flooring throughout
- LED lighting
- Interior white textured sheetrock and ceilings
- 4" Baseboard with 2-1/2"
- 32" Pocket doors Bath and Bedroom
- Laminate counters and backsplash
- Stainless top mount kitchen sink
- Faucet brushed chrome
- Cabinetry Essentials white raised panel
- Brushed nickel cabinet and door hardware
- 30" propane range black
- 30" Black rangehood vented
- Prep area for 30"x 69" refrigerator
- Prepped for stacked washer & propane dryer
- On demand 6.1 GPM tankless propane water heater
- Convection electric wall heat with thermostat bedroom & living room
- Main Electric 50 Amp, 240 V
- Top mount china bath sink
- Residential toilet
- 48" Shower, One-piece w/enclosure
- Framed Mirror over sink
- Towel and TP hardware satin nickel finish
- Brushed nickel cabinet and door hardware
- Prep for mini split

## OPTIONS

- Upgrade fiber cement lap siding front door side & hitch end fiber
- Full light entry door with Built-in blinds
- Upgraded entry door lockset w/ORB finish
- Porchlight package w/upgrade fixtures
- Transom window over the entry
- TV living room
- LED can light packages Living room and Bedroom
- Appliance Stainless Steel package including Micro/rangehood, Range, Refrigerator (w/ ice maker) & Dishwasher
- Garbage disposal
- Level III cabinets w/extended height overheads, soft close doors & drawers including 3" top trim
- Upgrade cabinet hardware
- Optional 96" bath linen cab
- Added drawer banks in bath and kitchen/Upgraded faucets in Kitchen & Bath
- ORB clear glass shower enclosure
- Upgrade shower fixtures, TP & towel bars in Bath to ORB
- Added ceiling fan prep in Bedroom plus ceiling fan fixtures in both
- Dual-zone mini-split system
- Upgrade custom tile kitchen & bath
- Added drawer banks in kitchen and bath
- Dual matte black sconce lighting in the bath
- LED can light above shower
- Medicine cabinet in bath

**Base Price**  
**\$79,995**



**Options Total**  
**\$22,000**



**As Shown**  
**\$101,995**

VIN ....3107  
9' 2" wide x 40' long x 14' 2" tall  
Approximately 376 sq. ft.  
16,680 lb. dry weight

\*Price does not include doc fees,  
freight & applicable taxes.  
Furnishings and decor not  
included

800.605.8329 | info@TinyMH.com | www.TinyMountainHouses.com