

# MT Gabriella

## By Tiny Mountain Houses

Located in Klamath Falls, OR  
Recreational Vehicle– DOT Compliant

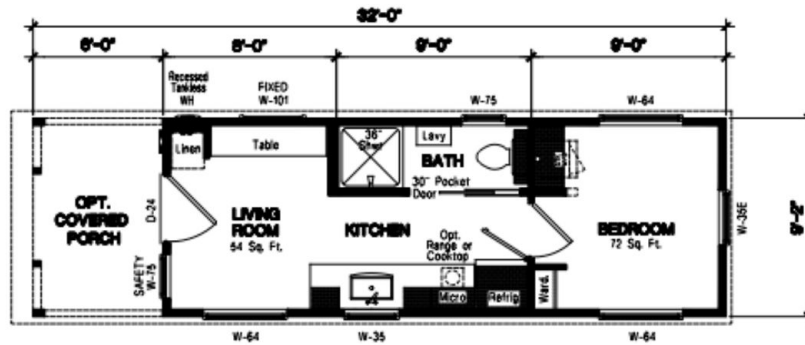

### STANDARDS

- Deck over floorplan ( No wheel wells)
- Windows residential Low E glazed, Argon gas 46" tall
- Insulation Floor R19, Ceiling R28, Walls R-11
- Residential 40-year hardboard siding
- Metal standing seam 40 Year roof
- Single slope shed style contemporary roof with eaves
- 36" entry door with a deadbolt
- 5/4 Rough-sawn trim throughout
- Entry light & Electrical outlet/Patio plug
- Vinyl flooring throughout
- LED lighting
- Interior white textured sheetrock walls & ceilings
- 4" Baseboard with 2-1/2"
- 32" Pocket doors Bath and Bedroom
- Laminate counters and backsplash
- Stainless 24" top mount kitchen sink
- Faucet brushed chrome
- Cabinetry Essentials white raised panel
- Built-in snack bar/desk
- Brushed nickel cabinet and door hardware
- Cooktop 2 burner electric
- 24" Black rangehood vented
- 7 CF Stainless steel refrigerator
- On-demand 6.1 GPM tankless propane water heater
- Convection electric wall heat with a thermostat in the bedroom & living room
- Main Electric 50 Amp, 240 V
- Petite bath sink W/Base cabinet
- Residential toilet
- One-piece 36" Shower
- Framed Mirror over sink
- Towel and TP hardware satin nickel finish (shipped loose)
- Brushed nickel cabinet and door hardware

### OPTIONS

- Board n Batten exterior on Kitchen sidewall & Porch end wall
- 6' Covered porch w/custom railings
- Added bedroom sidewall window
- Porch lighting package w/ceiling fan & LED can lights
- Switched exterior Christmas lighting electrical outlet
- Full lite entry door w/built-in blinds custom painted
- Stainless steel 24" microwave/rangehood exterior vented
- Stainless steel upgrade refrigerator
- Upgrade tile backsplash vertical/horizontal application
- Mini-split ductless heating and cooling system
- Prep for single unit W/D in bedroom
- 50 AMP 25' ship-to-shore RV power cord
- Extended height bath linen cabinet above toilet
- Level V Knotty Hickory cabinetry w/extended height overheads & soft close doors & drawers, with upgraded drawer guides
- Extended height closet cab and W/D overhead cab in bedroom closet area
- LED can light package in bedroom
- Ceiling fan prep with ceiling fan fixtures in the living and bedroom
- LED TV on a swivel mount in L/RM
- Butcher block snack bar exch std.

**Base Price**  
**\$59,900**



**Options Total**  
**\$24,415**



**As Shown**  
**\$84,315**

\*Price does not include doc fees,  
freight & applicable taxes.  
Furnishings and decor not  
included

Vin .... 31002  
9' 2" wide x 26' long  
(32' including porch) x  
14' 2" tall  
Approximately 278 sq.  
ft. (not including porch)  
9,380 lb.dry weight