

# MT Gabriella

By Tiny Mountain Houses

Located in Silverton, OR

Recreational Vehicle– DOT Compliant

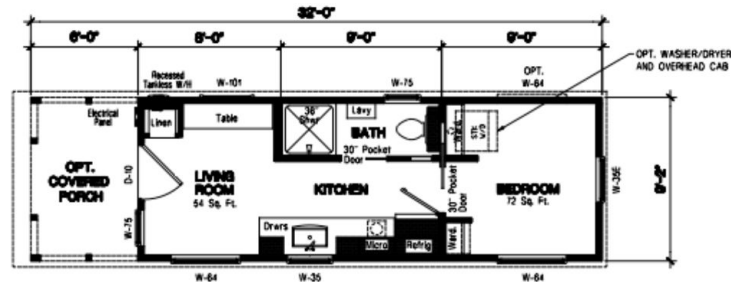

## STANDARDS

- Deck over floorplan ( No wheel wells)
- 4 integrated scissor jacks
- Windows residential Low E glazed, Argon gas 46" tall
- Insulation Floor R19, Ceiling R28, Walls R-11
- Residential 40-year hardboard siding
- Metal standing seam 40 Year roof
- Single slope shed style contemporary roof with eaves
- 36" entry door with a deadbolt
- 5/4 Rough-sawn trim throughout
- Entry light & Electrical outlet/Patio plug
- Vinyl flooring throughout
- LED lighting
- Interior white textured sheetrock walls & ceilings
- 4" Baseboard with 2-1/2"
- 32" Pocket doors Bath and Bedroom
- Laminate counters and backsplash
- Stainless 24" top mount kitchen sink
- Faucet brushed chrome
- Cabinetry Essentials white raised panel
- Built-in snack bar/desk w/ laminate top
- Brushed nickel cabinet and door hardware
- Cooktop 2 burner electric
- 24" Black rangehood vented
- 7 CF Stainless steel refrigerator
- On-demand 6.1 GPM tankless propane water heater
- Convection electric wall heat with a thermostat in the bedroom & living room
- Main Electric 50 Amp, 240 V
- Petite bath sink W/Base cabinet
- Residential toilet
- One-piece 36" Shower
- Framed Mirror over sink
- Towel and TP hardware satin nickel finish (shipped loose)
- Brushed nickel cabinet and door hardware

## OPTIONS

- Board n Batten exterior on Kitchen sidewall & Porch end wall
- 6' Covered porch w/custom railings
- Added bedroom sidewall window
- Porch lighting package w/ceiling fan & LED can lights
- Switched exterior Christmas lighting electrical outlet
- Full lite entry door w/built-in blinds custom painted
- Stainless steel 24" microwave/rangehood exterior vented
- Stainless steel upgrade refrigerator
- Upgrade tile backsplash
- Mini-split ductless heating and cooling system
- Prep for single unit W/D in bedroom
- 50 AMP 25' ship-to-shore RV power cord
- Extended height bath linen cabinet above toilet
- Level V Knotty Hickory cabinetry w/extended height overheads & soft close doors & drawers, with upgraded drawer guides
- Extended height closet cab and W/D overhead cab in bedroom closet area
- LED can light package in bedroom
- Ceiling fan prep with ceiling fan fixtures in the living and bedroom
- Level 3 arched cab hardware matte black square
- 2" Faux wood white window treatments t/out
- LED TV on a swivel mount in L/RM
- Butcher block snack bar exch std.

**Base Price**  
**\$59,900**



**Options Total**  
**\$25,135**



**As Shown**  
**\$85,035**

\*Price does not include doc fees, freight & applicable taxes. Furnishings and decor not included

VIN ....31006  
9' 2" wide x 26' long  
(32' including porch) x  
14' 2" tall  
Approximately 278 sq.  
ft. (not including porch)  
9,380 lb.dry weight

800.605.8329 | info@TinyMH.com | www.TinyMountainHouses.com