

Columbia II

By Tiny Mountain Houses
Recreational Vehicle- DOT Compliant

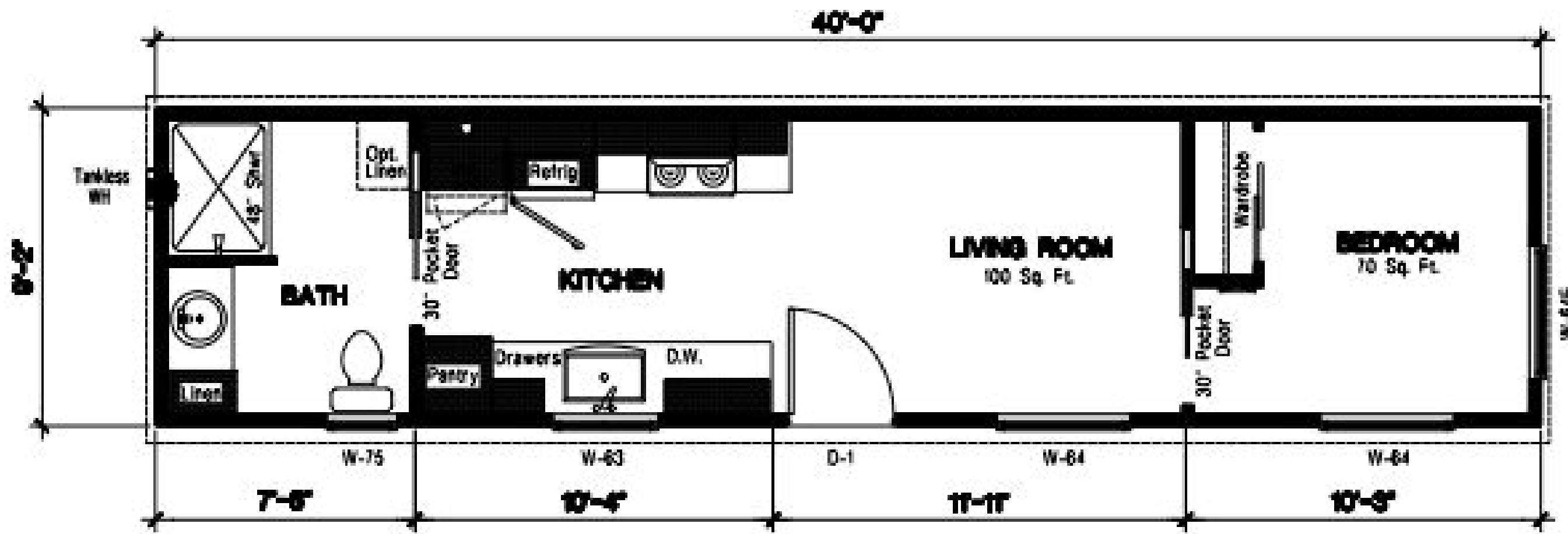

Want to get pricing on
your own Columbia II?
Scan the QR Code!



STANDARDS

- Deck over floorplan (No wheel wells)
- 4 integrated scissor jacks
- Windows residential Low E glazed, Argon gas 46" tall
- Insulation Floor R19, Ceiling R28, Walls R-11
- Residential 50-year warranty siding
- Metal standing seam 40 Year warranty roof
- Switched exterior holiday lights outlet
- Single slope shed style contemporary roof with eaves
- 36" Half lite entry door with a deadbolt
- 5/4 Rough-sawn trim throughout
- Porchlight & Electrical outlet/Patio plug & hosebibb
- Vinyl flooring throughout
- LED can lighting
- Interior white textured sheetrock and ceilings
- 4" Baseboard with 2-1/2" window & door trim
- 32" Pocket doors Bath and Bedroom
- Laminate counters w/ bullnose edge and backsplash
- Stainless top mount kitchen sink
- Kitchen faucet chrome - commercial style
- Cabinetry Essentials white raised panel
- Brushed nickel cabinet and door hardware
- 30" propane range black
- 30" Black rangehood vented
- Prep area for refrigerator
- Prepped for stacked washer & propane dryer
- Residential On demand 5.1 GPM tankless propane water heater
- Convection electric wall heat with thermostat bedroom & living room
- Main Electric 50 Amp, 240 V
- Top mount china bath sink
- Residential toilet
- 48" Shower, One-piece fiberglass
- Framed Mirror over sink
- Towel and TP hardware satin nickel finish
- Prep for mini split

OPTIONS

- Upgrade fiber cement lap siding front door side & hitch end
- Full light entry door with Built-in blinds
- Upgrade entry door lockset w/ORB finish thumbblatch
- Porchlight package w/upgrade fixtures (4)
- Transom window over the entry
- LED TV living room on swivel mount w/ high elect outlet
- LED can light packages Living room and Bedroom
- Appliance Stainless Steel package including Micro/rangehood, Range, Refrigerator (w/ ice maker) & Dishwasher
- Garbage disposal
- Level III cabinets w/extended height overheads, soft close doors & drawers including 3" top trim & detail bottom trim
- Upgrade cabinet hardware - matte black
- Optional 96" bath linen cab
- Pull out trash drawer - kitchen
- 2" Faux wood window treatments except bath
- ORB clear glass shower enclosure
- Upgrade ORB fixtures in kitchen & bath incl TP & towel bars
- Added ceiling fan prep in Bedroom plus ceiling fan fixtures in both LRM & BRM
- Dual-zone mini-split heating/ cooling system
- Upgrade custom tile kitchen & bath
- Added drawer banks in kitchen and bath
- Dual matte black sconce lighting in the bath
- LED can light above shower
- Beveled edge mirrored medicine cabinet in bath
- Custom capped BRM closet
- Upgraded bath mirror trim
- Craftsman interior trim pkg

Base Price
\$79,998



Options Total
\$27,450



As Shown
\$107,445

VIN012
9' 2" wide x 40' long
x 14'0" tall
Approximately 376 sq. ft.
16,680 lb. dry weight

*Price does not include doc fees, freight & applicable taxes. Furnishings and decor not included

800.605.8329 | info@TinyMH.com | www.TinyMountainHouses.com