

Columbia II

By Tiny Mountain Houses
Recreational Vehicle– DOT Compliant

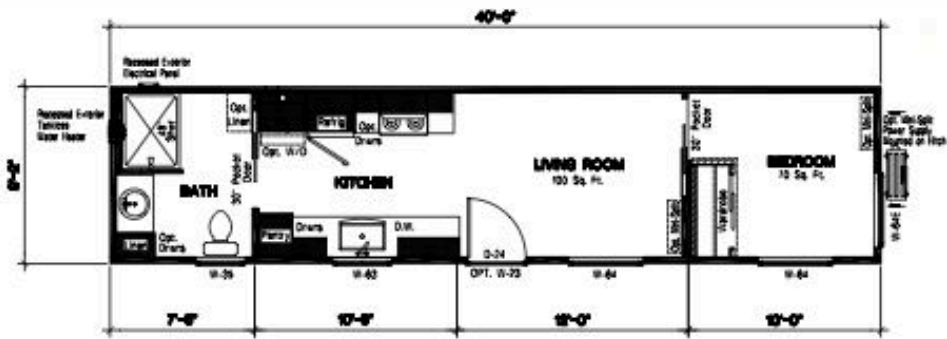

Want to get pricing on
your own Columbia II?
Scan the QR Code!



STANDARDS

- Deck over floorplan (No wheel wells)
- Custom LRM & Kitchen ceiling finish
- 4 integrated scissor jacks
- Windows residential Low E glazed, Argon gas
- Insulation Floor R19, Ceiling R28, Walls R-11
- Residential 50-year warranty siding
- Metal standing seam 40 Year warranty roof
- Switched exterior holiday lights outlet
- Single slope shed contemporary roof w/ eaves
- 36" Half lite entry door with a deadbolt
- 5/4 Rough-sawn trim throughout
- Porchlight, Patio plug & hosebibb
- Vinyl flooring throughout
- LED can lighting
- Interior white textured sheetrock and ceilings
- 4" Baseboard with 2-½" window & door trim
- 30" Pocket doors Bath and Bedroom
- Laminate counters w/ bullnose edge and backsplash
- Stainless top mount kitchen sink
- Kitchen faucet chrome
- Cabinetry Essentials white raised panel
- Brushed nickel cabinet and door hardware
- 30" propane range black
- 30" Black rangehood vented
- Prep area for refrigerator
- Prepped for stacked washer & propane dryer
- Residential On demand 5.1 GPM tankless propane water heater
- Convection electric wall heat with thermostat
- Main Electric 50 Amp, 240 V
- Top mount china bath sink
- Residential elongated toilet
- 48" Shower, One-piece fiberglass
- Framed Mirror over sink
- Towel and TP hardware satin nickel finish
- Prep for mini split

OPTIONS

- Optional Bedroom Layout
- Custom LRM & kitchen ceiling texture
- Fiber cement lap siding front door side & hitch end
- Full light entry door w/Built-in blinds - Custom finish
- Upgrade entry door lockset w/ORB finish
- Porchlight package w/upgrade fixtures (4)
- Transom window over the entry
- LED can light packages Living room and Bedroom
- 3 cm Quartz kitch countertops w/ undermount sink
- Custom built-in entertainment center including 42" electric fireplace and a 55" LED TV with butcher block mantel
- Undermount stainless steel kitchen sink
- Upgrade pot filler spring style kitchen faucet
- Stainless Steel appliance package including Micro/rangehood, Range, Refrigerator (w/ ice maker) & Dishwasher
- Garbage disposal
- Club Grey cabinets w/extended height overheads, soft close doors & drawers, including craftsman trim detail
- Upgrade cabinet hardware
- Optional 96" bath linen cab
- Pull out trash drawer - kitchen
- 2" Faux wood window treatments
- ORB clear glass shower enclosure
- Upgrade ORB bath fixtures incl TP & towel bars
- Ceiling fan prep in Bedroom plus wooden blade ceiling fan fixtures in LRM & BRM
- Dual-zone mini-split heating/ cooling system
- Upgrade custom tile kitchen & bath
- Added drawer banks in kitchen and bath
- Dual matte black sconce lighting in the bath
- LED can light above shower
- Beveled edge mirrored medicine cabinet in bath
- Custom capped BRM closet
- Upgraded bath mirror trim
- Craftsman interior millwork pkg

Base Price
\$84,500



Options Total
\$33,935



As Shown
\$118,435

VIN31012
9' 2" wide x 40' long
x 14'0" tall
Approximately 376 sq. ft.
16,680 lb. dry weight

*Price does not include doc fees, freight & applicable taxes, furnishings, and decor.

[*Pricing subject to change](#)

November 14, 2025