

BROOKSIDE

2 Bedroom, 48" shower 42' 8"

By Tiny Mountain Houses
Recreational Vehicle– DOT Compliant

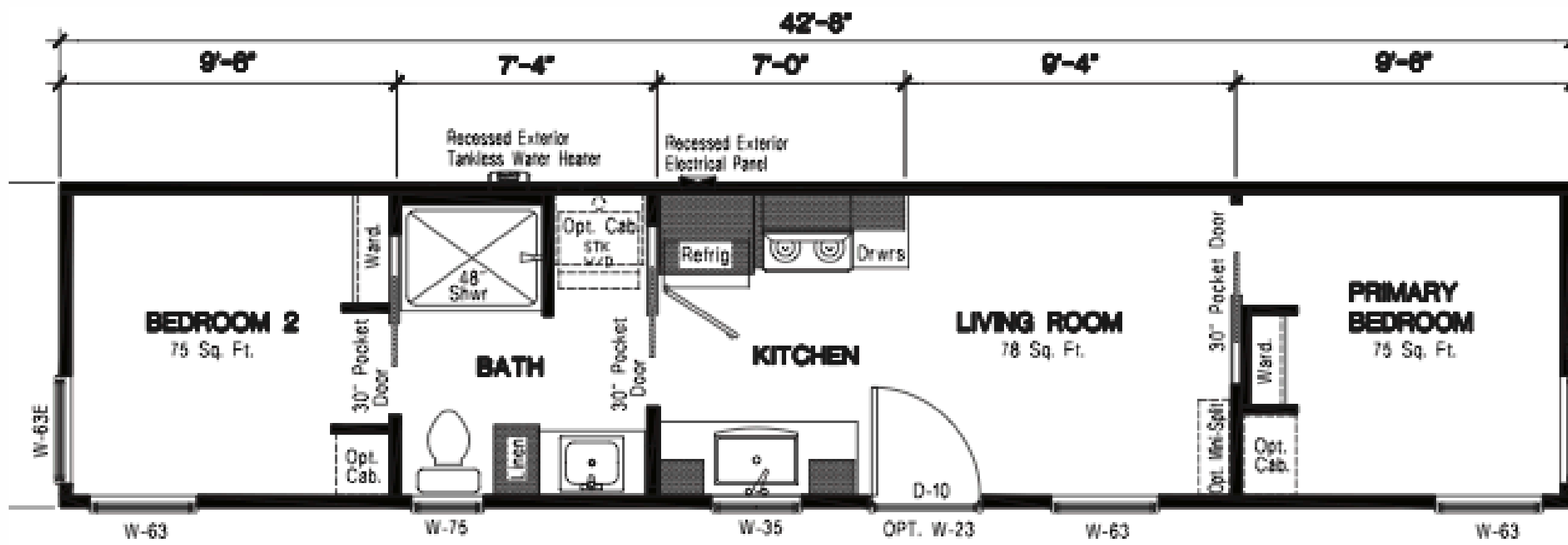

Want to get pricing on
your own Brookside?
Scan the QR Code!



STANDARDS

- Deck over floorplan (No wheel wells)
- 4 integrated scissor jacks
- Windows residential Low E glazed, Argon gas
- Insulation Floor R19, Ceiling R28, Walls R-11
- Residential LP Siding W/50 Warranty
- Metal standing seam roof
- Switched exterior holiday electrical outlet
- Single slope shed style contemporary roof with eaves
- 36" Half lite entry door with a deadbolt
- 5/4 Rough-sawn trim throughout
- Exterior Porchlight & Patio plug & Hose bibb
- Vinyl flooring throughout
- LED can lighting
- Interior textured sheetrock and ceilings painted white
- 4" Baseboard with 2-1/2" Window & Door trim
- Pocket doors Bath & Bedrooms
- Laminate backsplash & counters W/bullnose edging
- Stainless top mount kitchen sink
- Chrome Kitchen Faucet
- Cabinetry "Essentials" white raised panel - Vinyl wrap
- Brushed nickel cabinet and door hardware knobs
- 30" propane range black
- 30" Black rangehood vented
- Prep area for refrigerator
- Prep for RV washer & 110v dryer
- On-demand 5.1 GPM residential tankless propane water heater
- Convection electric wall heater
- Main Electric 50 Amp, 240 V W/25' RV Ship to Shore Power cord
- Top mount china bath sink
- Extended-height bath linen cabinet
- Residential elongated toilet
- 48" Fiberglass Shower, One-piece
- Mirror over sink
- Bath switched exhaust fan w/ light
- Towel and TP hardware satin nickel finish
- Brushed nickel cabinet and door hardware
- Prep for Living room ceiling fan
- Rocker-style light switches

OPTIONS

- Upgrade exterior combo board and batten siding two sides
- Transom window over the entry
- Second porchlight
- Upgraded contemporary porch lights
- Oil-rubbed bronze thumb latch entry thumb latch lockset
- LED TV in living room w/swivel mount & high-elect outlet
- Prep for TV in both bedrooms
- Wall-mount curved electric fireplace
- Butcher block mantel
- LED 4 can light packages in the living room & bedroom's
- Added ceiling fans LRM & Bedroom's
- Stainless range & micro/rangehood & 18 CF Refrigerator W/Icemaker
- Commercial satin nickel spring faucet
- Sage shaker cabinets, W/extended height overheads, soft close doors & drawers, including contemporary cabinet trim package
- Trash/compost pullout
- Upgrade satin nickel custom cabinet hardware
- Upgrade tile kitchen & bath W/schlueter edge
- Single unit washer/ dryer 110v w/ super dry function
- Extended Height Linen cabinet in bath above W/D area
- Triple satin nickel sconce lights over bath sink
- Satin nickel shower enclosure
- Beveled edge mirrored medicine cabinet bathroom
- LED light over the shower
- T & G pine ceiling in LRM & Kitchen W/matte poly clear coat finish
- Craftsman interior trim package throughout painted white
- 2" faux wood blinds t/ out
- Triple- zone mini split heating and cooling system
- Both bedrooms with closet cabinets W/dresser drawers & storage cubby w/ Butcherblock shelves & elect outlets
- Butcherblock table w/ chunky edge
- Prep for air exchange unit
- Desk w/ shelving above area Bedroom 2

BASE PRICE
\$97,350



OPTIONS TOTAL
\$35,410



AS SHOWN
\$132,760

VIN ...31002
9' 2" wide x 42'8" long
x 14'0" tall
Approximately 396 sq. ft.
15,950 lb. dry weight

Not included doc fees, applicable taxes, furnishings & decor

800.605.8329 | info@TinyMH.com | www.TinyMountainHouses.com